

# Compositions and Lighting

## Compositions



"Simply." by Julien Belli is licensed under CC BY 2.0.

Diagonals: Lines that go diagonal or sideways; ex. designed outlines on a wall pointing towards a hallway

Rule of Thirds: Dividing the image into 9 boxes. Placing key elements at the intersections or along the lines helps visual balance and engage attention to an object.



"Boston Rule-of-Thirds HDR" by Rick Harris is licensed under CC BY-SA 2.0.



"golden ratio lighthouse stairs" by justgrimes is licensed under CC BY-SA 2.0.

Golden Ratio: Similar to the Rule of Thirds, placing key elements along the spiral or grid can create a pleasing and natural effect.

## Lighting

### Rembrandt

Needed: One continuous light or strobe and one reflector

Distinguishable by a triangle seen under one of the model's eye due to reflector.

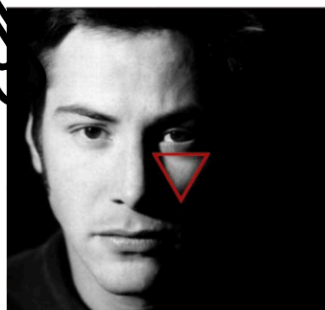
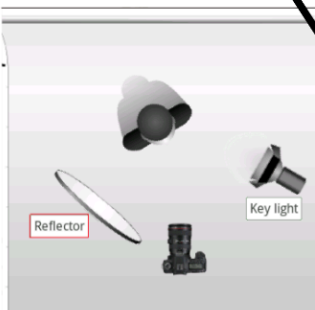

### Rim

Needed: Rim light, Key light, Fill light, Background light

Involves creating a thin line of light to outline the shape of the subject. Color gels can be optional, as shown below.

